



SERVING THE FOOD INDUSTRY SINCE 1951

Curved Glass Floor Refrigerated Showcase

Item:	44387	44502	44503	44504
Model:	RS-CN-0271	RS-CN-0371	RS-CN-0471	RS-CN-0571



44387 - 36"



44502 - 48"



44503 - 60"



44504 - 72"

Attractively display food merchandise and increase impulse sales.

Omcan's Curved Glass Floor Refrigerated Display Case provides an economical solution for displaying your products in style. With a sleek tempered glass exterior, bright interior LED lighting, and digital temperature control, it ensures optimal visibility and ease of use.

The fan cooling and automatic defrost systems maintain consistent performance, while the smooth surfaces make cleaning simple. Perfect for delis, cafés, and sandwich shops.

FEATURES:

- Brilliant LED illumination under each shelf
- Digital temperature controller & display
- Adjustable shelves
- Four-sided double glass
- Automatic defrost
- Ventilated cooling system
- Stainless steel base

Telephone: 1-800-465-0234

Fax: (905) 607-0234

Email: sales@omcan.com

Website: www.omcan.com

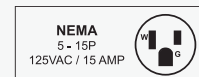
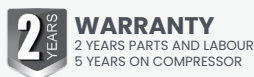

Authorized Dealer

TECHNICAL SPECIFICATION

Features	36" Wide 310L / 10.95 cu.ft	48" Wide 420 L / 14.83 cu.ft	60" Wide 535 L / 18.89 cu.ft	72" Wide 650 L / 22.95 cu.ft
Item	44387	44502	44503	44504
Model	RS-CN-0271	RS-CN-0371	RS-CN-0471	RS-CN-0571
Capacity	310L / 10.95 cu. ft	420 L / 14.83 cu.ft	535 L / 18.89 cu. ft	650 L / 22.95 cu.ft
Power	600 W	540 W	605 W	630W
Number of Shelves	3	3	3	3
Lamp Power	23 W	41 W	50 W	60 W
Temperature Range	0-12°C / 32-54°F	0-12°C / 32-54°F	0-12°C / 32-54°F	0-12°C / 32-54°F
Electrical	110V / 60Hz / 1Ph	110V / 60Hz / 1Ph	110V / 60Hz / 1Ph	110V / 60Hz / 1Ph
Rated Current	7.1A	7.4 A	7.1 A	6.8 A
Refrigerant	R290	R290	R290	R290
Blowing Gas	Front	Front	Front	Front
Shelf Size	36.8" x 12" / 935 x 311mm 36.8" x 14" / 935 x 361mm	48.6" x 10" / 1235 x 261mm 48.6" x 14.4" / 1235 x 311mm 48.6" x 14.6" / 1235 x 371mm	55.7" x 10" / 1416 x 253mm 55.7x 14.4" / 1416 x 367mm	33" x 10" / 843 x 253mm 33" x 14" / 843 x 367mm
Inner Dimensions (WDH)	33" x 23" x 32.7" / 845 x 585 x 830mm	45" x 23" x 32.7" / 1145 x 585 x 830 mm	57" x 23" x 32.67" / 1445 x 585 x 830 mm	33" x 23" x 32.7" / 845 x 585 x 830mm
Net Weight	322 lbs / 146 kgs	390.2 lbs / 177 kgs	463 lbs / 210 kgs	518lbs / 235kgs
Net Dimensions (WDH)	36" x 26.8" x 55.5" / 925 x 680 x 1410mm	48" x 26.8" x 56" / 1225 x 680 x 1420 mm	60" x 26.8" x 56" / 1525 x 680 x 1420 m	72" x 26.8" x 56" / 1825 x 680 x 1420mm
Gross Weight	419 lbs / 190 kgs	500.4 lbs / 227 kgs	542.3 lbs / 246 kgs	617.3 lbs. / 280 kgs
Gross Dimensions (WDH)	41" x 31" x 65" / 1045 x 785 x 1655mm	53" x 32" x 65" / 1345 x 785 x 1655 mm	66.5" x 32.7" x 63.4" / 1690 x 830 x 1610 mm	78.3" x 32.7" x 63" / 1990 x 830 x 1610mm

TECHNICAL DRAWING

Item: 44387

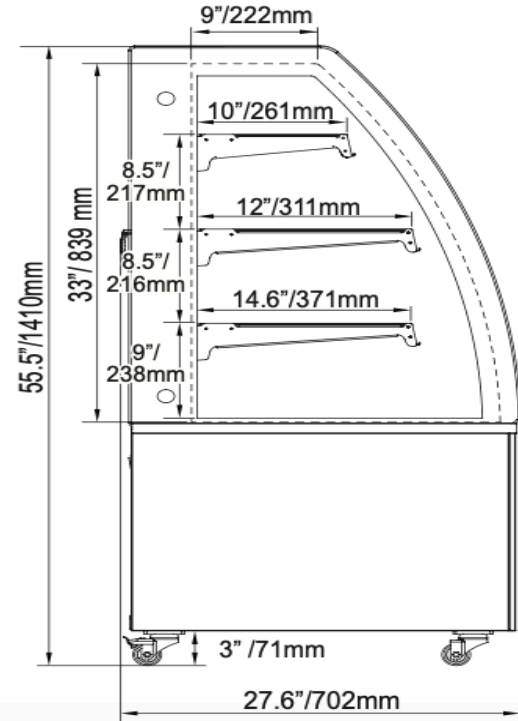
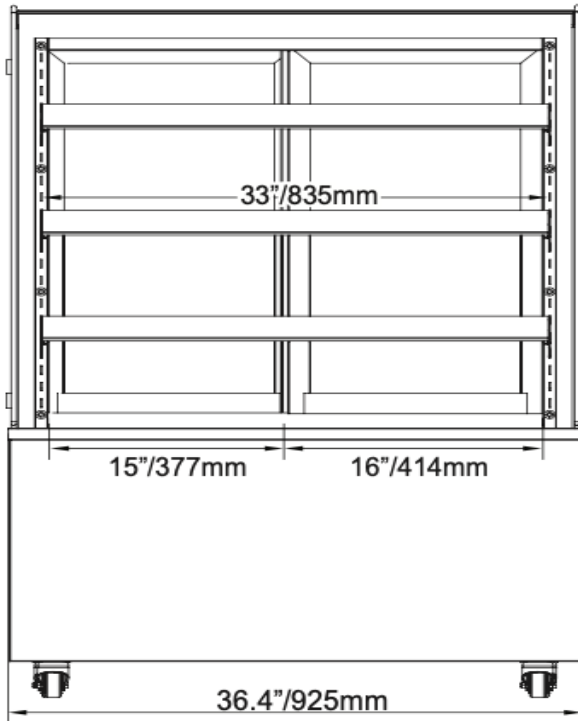

Item: 44502

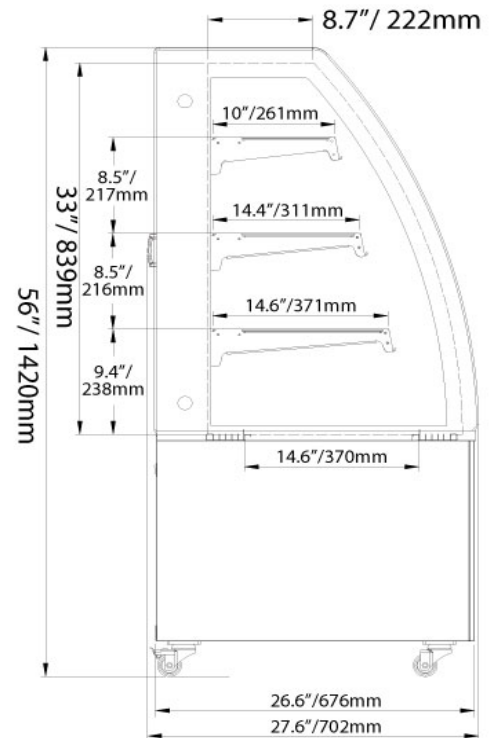
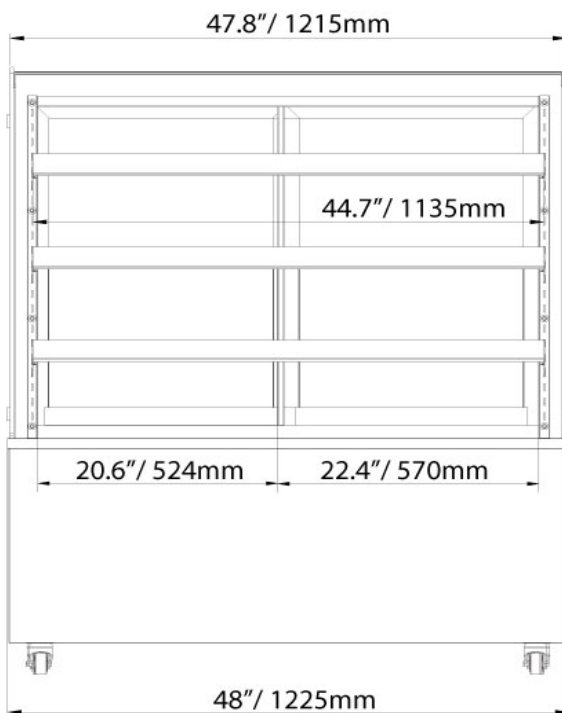

TECHNICAL DRAWING

